

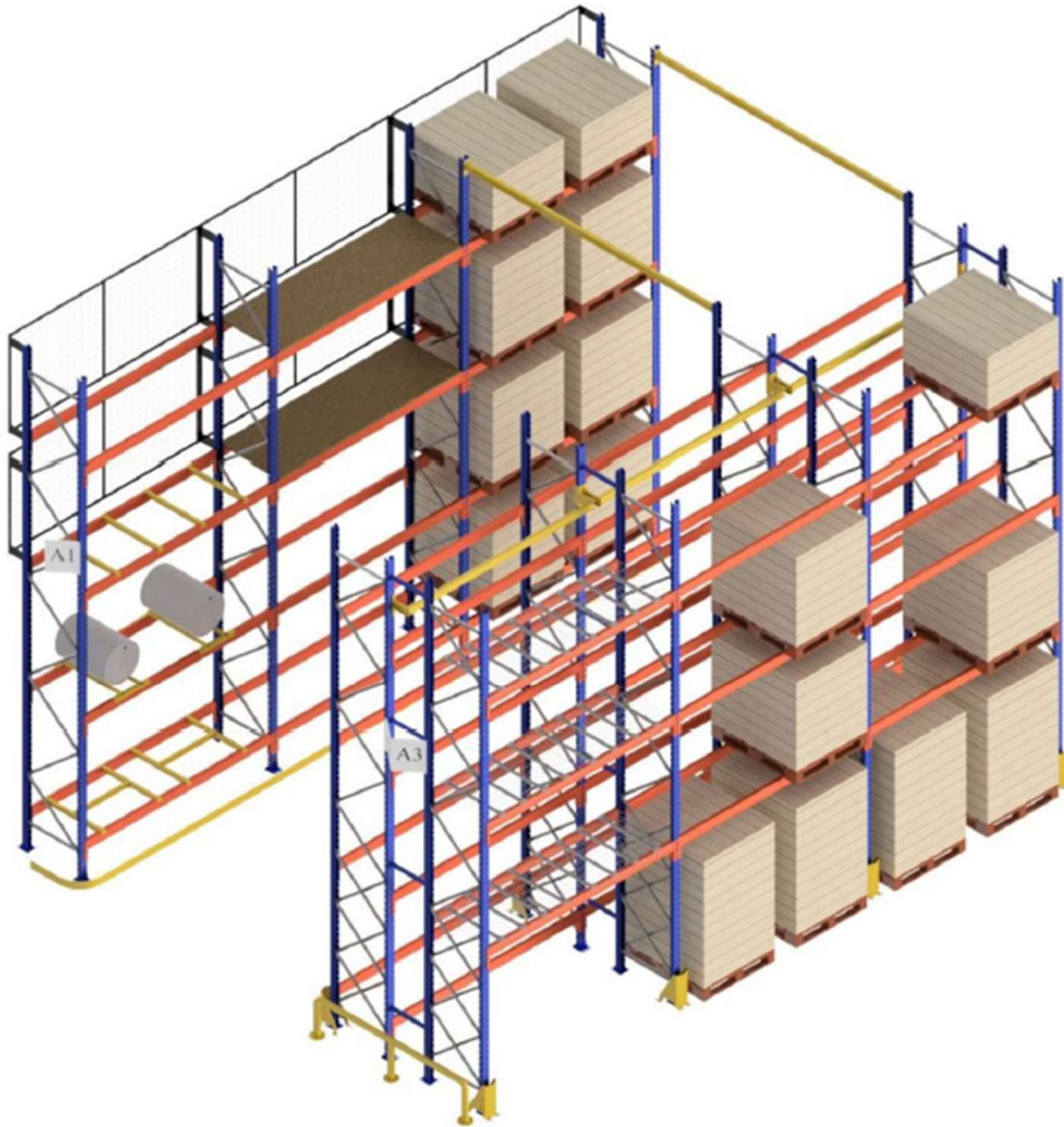

Selective Pallet Racking User Manual



41 Gaine Road
Dandenong South, Vic 3175
T: (03) 8787 8877
E: sales@erectarack.com.au

www.erectarack.com.au

Table of Contents

Introduction	4
Selective Pallet Racking System Overview	5
Design and Configuration:.....	5
Components of Selective Pallet Racking	6
Uprights (Frames):.....	6
Row Spacer:.....	7
Stand Off Row Spacer.....	8
Beams (Load Beams):.....	9
Wire Decks or Pallet Supports:.....	10
Column Guards and Rack Protectors:	11
Anchors and Footplates:	12
Pallet Types	13
Wood Pallets:	13
Plastic Pallets:.....	13
Metal Pallets:.....	13
Pressed Wood Pallets:.....	13
Paper Pallets:.....	13
Specialty Pallets:.....	13
Safety Guidelines.....	14
Load Capacity:	14
Weight Distribution:.....	15
Load Handling and Stacking Techniques	16
Safe Load Handling:.....	16
Stable Load Placement and Securing	16
Stacking Height and Weight Limits:.....	16
Proper Pallet Orientation:	16
Overhang Prevention:	16
Caution with Fragile or Unstable Loads:	16
Aisle Safety and Clearances.....	17
Adequate Aisle Width:	17
Clear Pathways:	17
Marked Aisles and Walkways:.....	17
Obstacle Avoidance:.....	17
Rack End Protection:	17
Safe Speed Limits:	17
Training and Awareness:	17

Regular Inspections:	17
Loading Pallets	18
Safe Working Load Signs	19
Clear and Visible Display:	19
Standardised Format:	19
Weight Capacity Information:	19
Relevant Information:	19
Design and Durability:	19
Compliance with Regulations:.....	19
Maintenance and Inspections.....	20
Scheduled Inspections:	20
Visual Inspections:.....	20
Load Capacity Verification:.....	20
Damage Assessment and Repair:	20
Rack Protection Measures:	20
Housekeeping and Load Placement:	20
Staff Training and Education:	20
Documentation and Record-Keeping:	20
Repair and Replacement of Components	23
Inspection and Evaluation:	23
Manufacturer Guidelines:	23
Qualified Personnel:	23
Component Repair:	23
Component Replacement:	23
Professional Assistance:	23
Documentation:	23
Visual Damage Inspection Report	24

Introduction

This manual provides essential guidelines and instructions for the safe and efficient use of selective pallet racking systems. It is designed to familiarise operators with the proper procedures for operating, inspecting, and maintaining selective pallet racking to ensure a safe working environment. Please read this manual carefully and follow the guidelines provided.

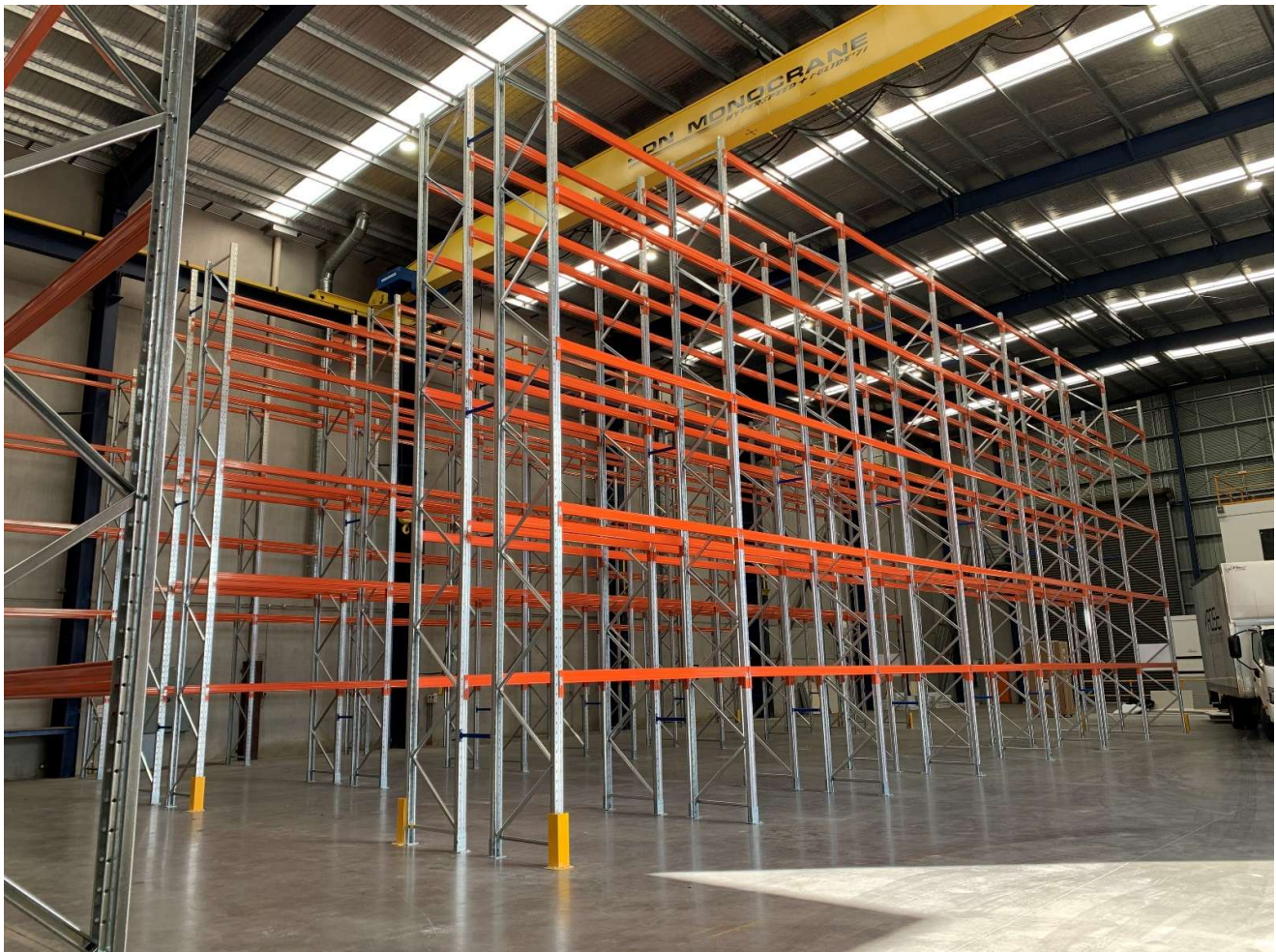

Selective Pallet Racking System Overview

Selective pallet racking is one of the most common and widely used storage systems in warehouses and distribution centres. It offers a versatile and efficient solution for storing palletised goods. Here is an overview of the selective pallet racking system:

Design and Configuration:

Selective pallet racking is designed with vertical upright frames and horizontal load beams that create multiple levels or shelves for pallet storage.

The system can be configured in single or back-to-back rows, allowing easy access to each pallet.

It provides direct access to every pallet stored, making it suitable for high-selectivity storage.

Easy Accessibility:

Selective racking provides unrestricted access to each pallet, allowing for quick and efficient picking and replenishment of goods.

Forklifts or other material handling equipment can easily manoeuvre within the aisles to access the desired pallets.

Adjustable Beam Heights:

The load beams in selective pallet racking are adjustable, allowing for flexibility in configuring the system to accommodate different pallet sizes and heights.

Beam levels can be easily adjusted to match the height requirements of various products.

Load Capacity and Safety:

Selective pallet racking systems are designed to support specific load capacities, which are determined by the manufacturer and depend on the quality of the components.

Adhering to load capacity limits and following proper load distribution and weight guidelines are essential for maintaining safety and structural integrity.

Versatility and Scalability:

Selective racking is highly versatile and can accommodate various pallet sizes, weights, and SKU variations.

It can be easily expanded or reconfigured to adapt to changing storage needs or facility layouts.

Compatibility with Handling Equipment:

Selective pallet racking is compatible with a wide range of material handling equipment, including forklifts, reach trucks, and pallet jacks.

It allows for seamless integration with existing equipment, optimising, workflow and efficiency.

Application and Industries:

Selective pallet racking is suitable for a wide range of industries, including warehousing, distribution, manufacturing, retail, and e-commerce.

It is ideal for storing goods with high turnover rates, diverse product ranges, and a need for direct access to individual pallets.

Selective pallet racking offers efficient space utilisation, easy access to inventory, and versatility in storage options. Its popularity stems from its ability to maximise storage capacity while providing accessibility and adaptability to meet changing business needs.

Components of Selective Pallet Racking

Uprights (Frames):

Uprights are the vertical columns that provide the structural support for the racking system. They are typically made of steel and are available in various heights and depths to accommodate different storage requirements. Uprights have evenly spaced holes or slots along their length, allowing for the insertion of load beams at different heights to create shelf levels.

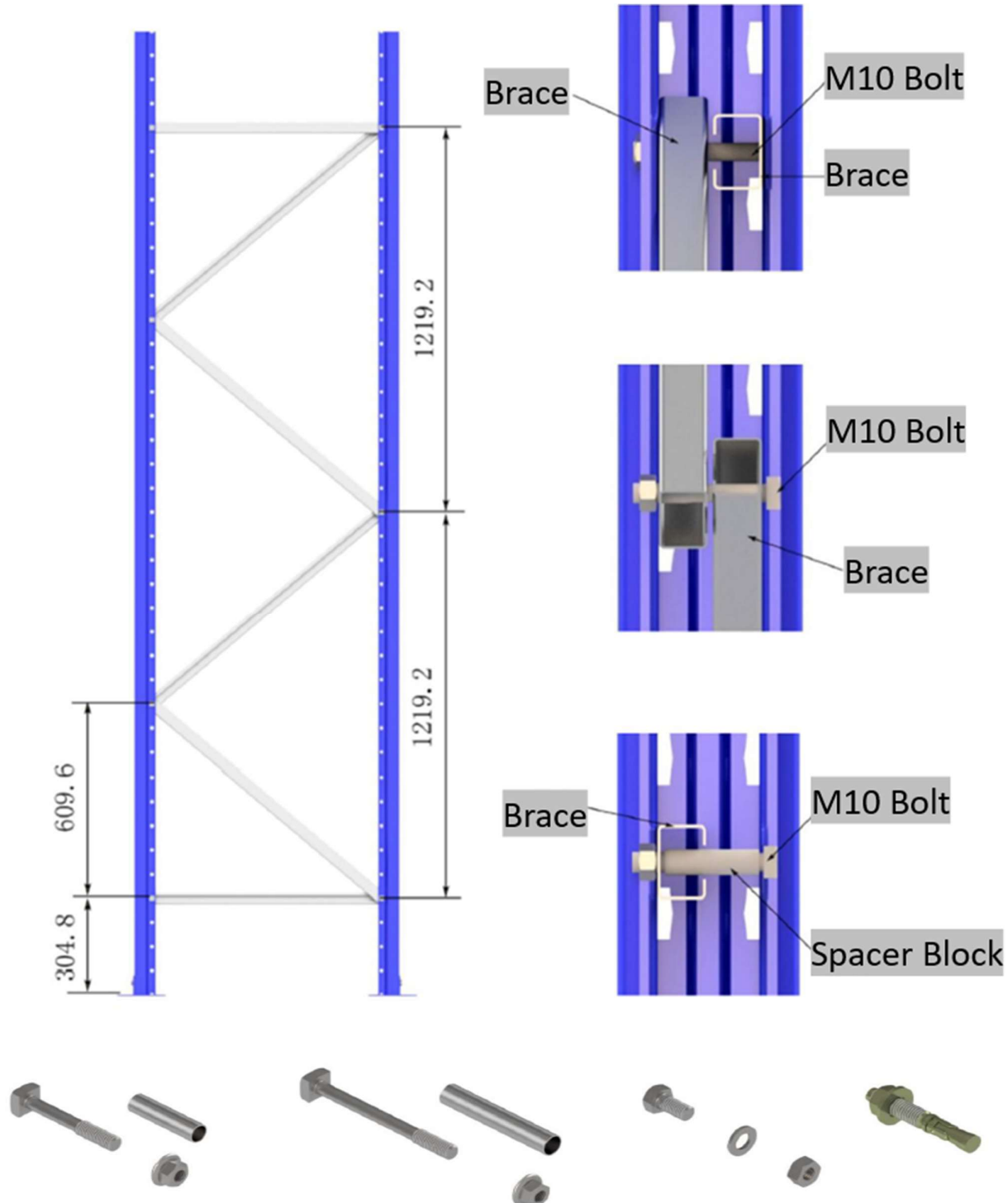

Row Spacer:

A row spacer is a component used in selective pallet racking systems to create a clear space between adjacent rows of racking. It is made of metal structure that is installed horizontally between upright frames along the length of the racking system. Standard sizes are 430mm and 600mm.

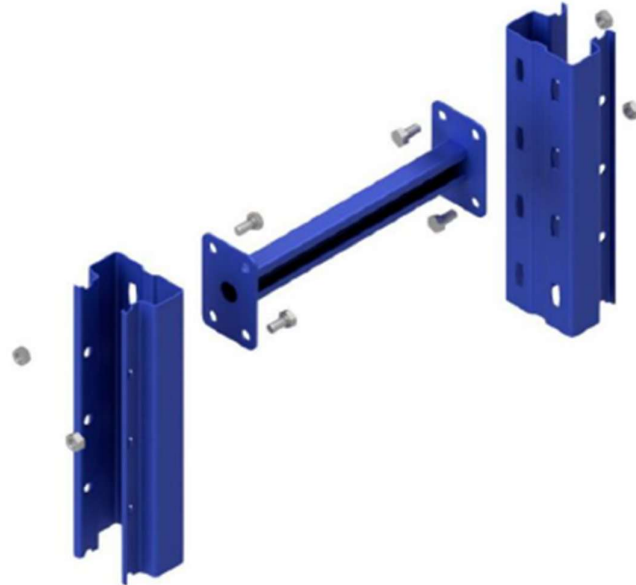

connection method

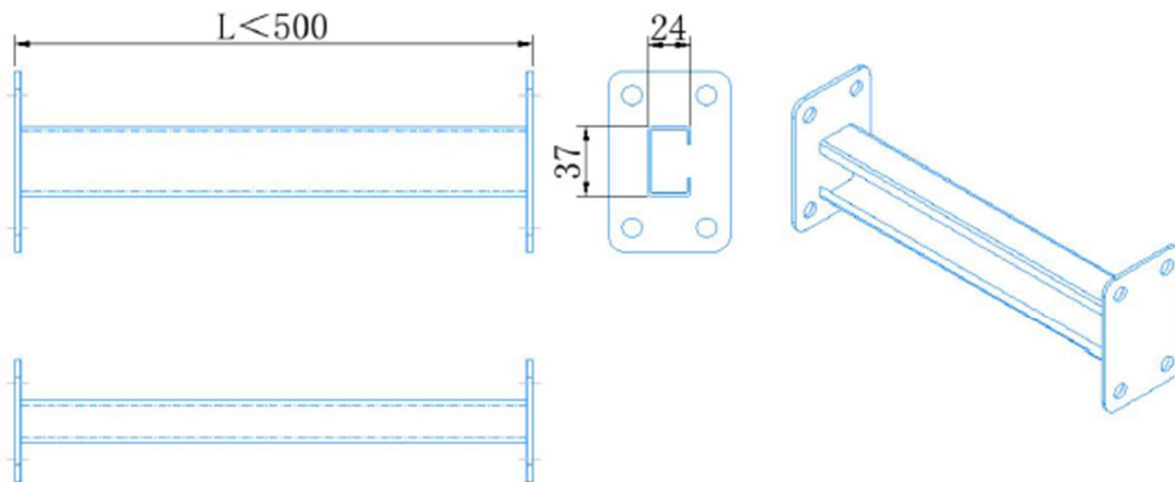

double-sided spacer

Stand Off Row Spacer

A stand-off is a specific component or accessory used to create a gap between the back of the pallet and the upright frame of the racking system.



connection method

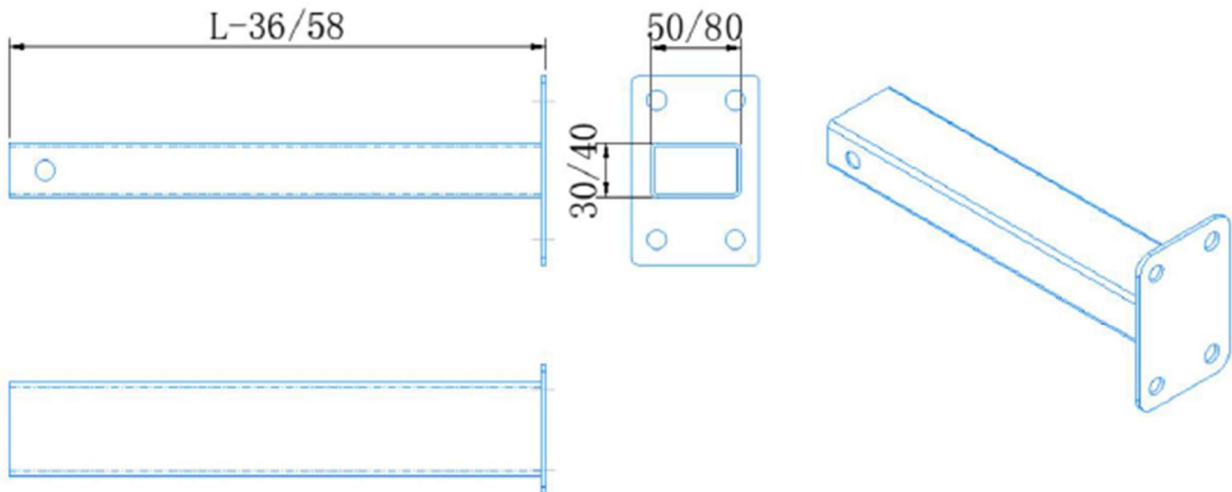

single spacer

Beams (Load Beams):

Beams are horizontal members that connect the uprights and form the shelves or levels on which the pallets are placed. They come in various lengths and load capacities to accommodate different pallet sizes and weights. Beams are typically adjustable, allowing for flexibility in configuring the racking system according to specific storage needs.

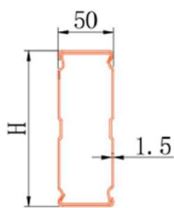

H=80/90/100/110/120/140

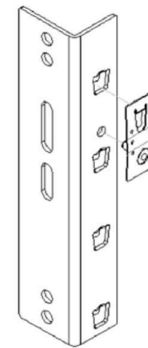
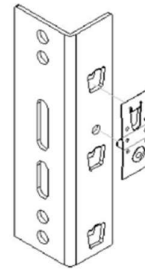
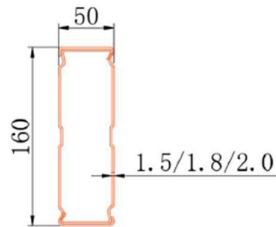

Wire Decks or Pallet Supports:

Wire decks or pallet supports are wire mesh panels placed on the load beams to provide support for the pallets.

They help distribute the weight evenly and prevent pallets from sagging or falling through the beams. Wire decks also improve visibility and allow better airflow, making them suitable for storing perishable or temperature-sensitive products.

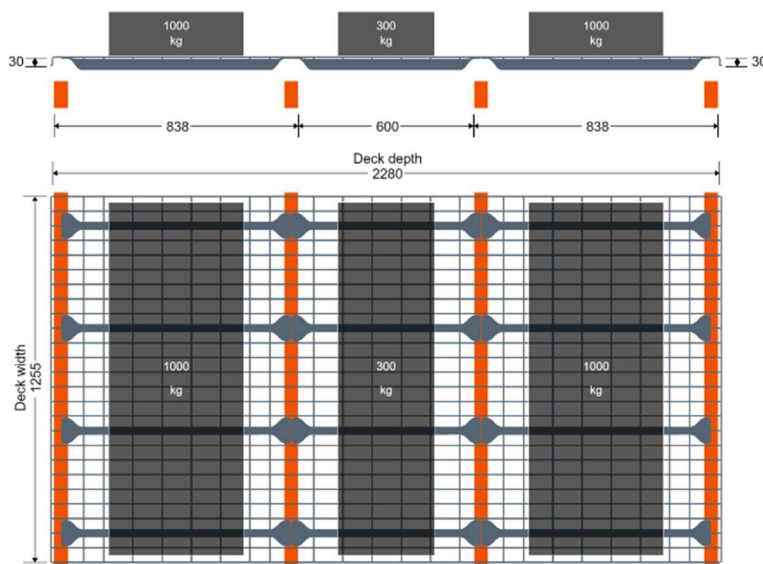
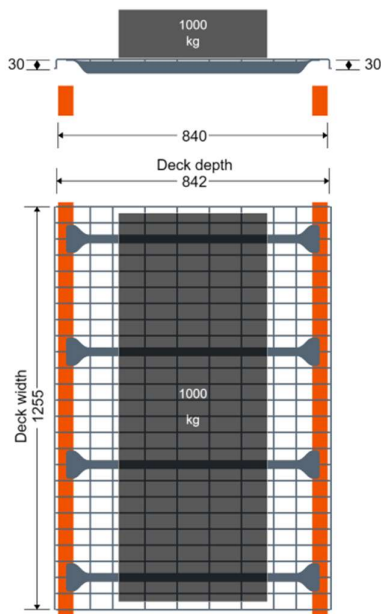

Mesh Deck Options:

Single Entry Racking

Depths from 838mm to 1219mm and widths from 1250mm to 1360mm.

Stand Off Racking

Depths from 838mm to 2218mm and widths from 1250mm to 1360mm.

Double Deep Racking

Depths from 2106mm to 2950mm and widths from 1250mm to 1360mm.

UDL

Loads from 10kg to 1,500kgs

Column Guards and Rack Protectors:

Column guards are protective devices installed at the base of the uprights to prevent damage from forklift collisions. They absorb impact and minimise the risk of upright deformation or collapse. Rack protectors are additional protective structures attached to the front and rear of the uprights to safeguard against accidental impacts from forklifts or other equipment.

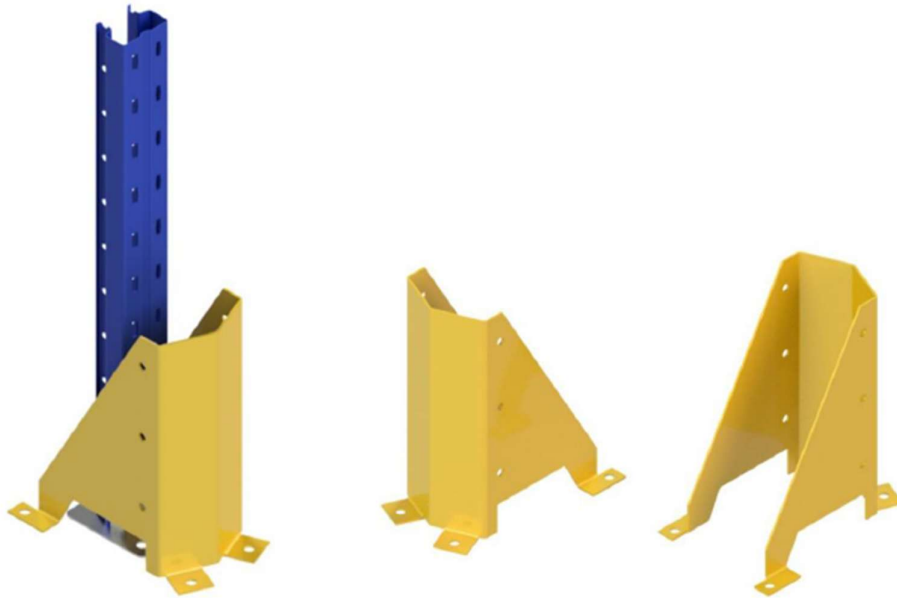

Column Guards designed to wrap around uprights and secure with 4 x M10 x 75 screw bolts.



Rack End Guards for total end rack protection secured with 8 x M10 x 75 screw bolts.



Upright Guard 800mm x 115mm fixed to the upright to deflect pallets from direct impact from pallet handling.

Anchors and Footplates:

Anchors are used to secure the pallet racking system to the floor, enhancing its stability and preventing movement or toppling. Footplates are large metal plates that provide a solid base for the uprights and distribute the weight over a larger surface area. These components work together to create a stable and efficient selective pallet racking system. It's essential to ensure that all components are properly installed, inspected, and maintained to ensure the safety and reliability of the racking system. Regular inspections should be conducted to identify any signs of damage or wear and address them promptly. All Upright uprights are secure with 2 x M10 x 100 screw bolts (AS 5216-2021) through each baseplate.



stamping feet

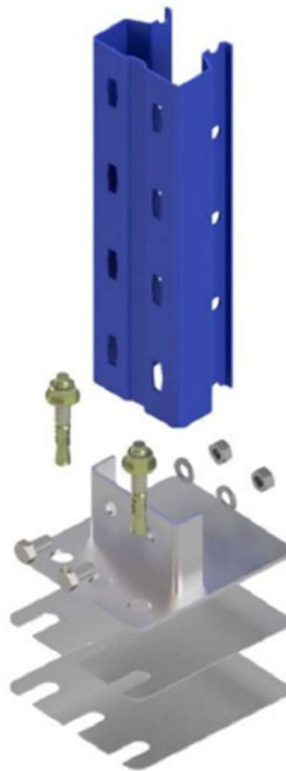

single row hole feet

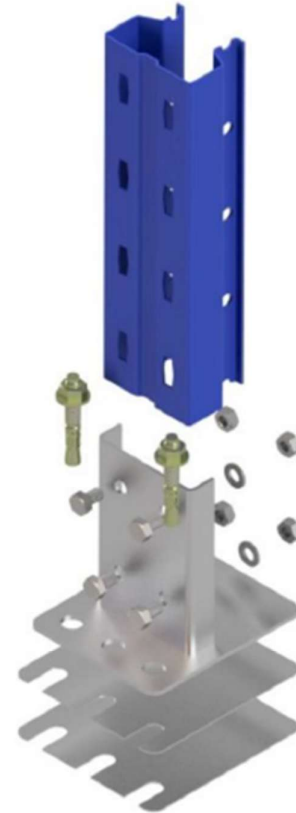

Double row hole feet

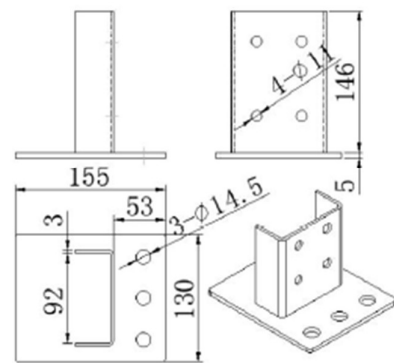
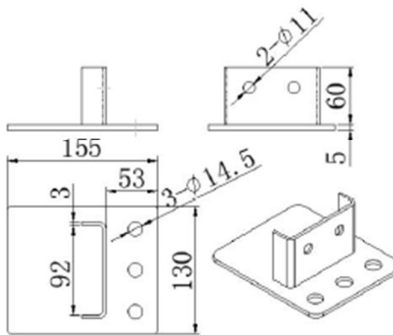
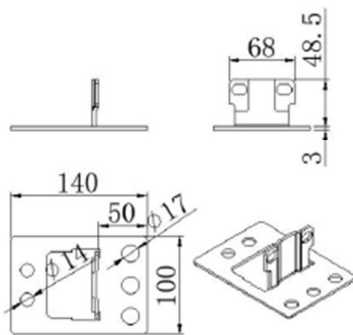

Pallet Types

There are various types of pallets used in material handling and logistics. Here are some common pallet types:

Wood Pallets:

Wood pallets are the most widely used type of pallets. They are typically made of hardwood or softwood and consist of top and bottom deck boards with stringers or blocks supporting them. Wood pallets are sturdy, affordable, and widely available. They can be easily repaired, recycled, or repurposed.

Plastic Pallets:

Plastic pallets are made from durable, lightweight, and weather-resistant materials, such as high-density polyethylene (HDPE) or polypropylene (PP). They are commonly used in industries where hygiene, cleanliness, and resistance to moisture or chemicals are important. Plastic pallets are non-absorbent, easy to clean, and can be stackable or nestable for efficient storage. They have a longer lifespan compared to wood pallets but are generally more expensive.

Metal Pallets:

Metal pallets are constructed from steel or aluminium. They are strong, durable, and suitable for heavy-duty applications or environments where fire safety is a concern. Metal pallets have a longer lifespan and can withstand high stacking loads, making them ideal for industrial and storage applications. However, they tend to be heavier and more expensive than other pallet types.

Pressed Wood Pallets:

Pressed wood pallets, also known as composite or engineered wood pallets, are made from recycled wood fibres combined with a binding agent. They are lightweight, consistent in size, and often have better dimensional accuracy compared to traditional wood pallets. Pressed wood pallets are typically used in industries where weight reduction and compliance with international shipping regulations are important.

Paper Pallets:

Paper pallets are lightweight, recyclable, and often used for temporary or lightweight applications. They are usually made from corrugated cardboard or other paper-based materials. Paper pallets are convenient for one-way shipping, export purposes, or industries where weight reduction and sustainability are prioritised.

Specialty Pallets:

Specialty pallets include custom-designed pallets to meet specific industry requirements or unique load characteristics. Examples include pallets with specific dimensions, special features like anti-slip surfaces or ergonomic designs, and pallets for specialised industries like pharmaceuticals or automotive.

The choice of pallet type depends on factors such as the specific application, load requirements, transportation method, regulations, and budget considerations. Each pallet type has its advantages and suitability for different industries and logistics operations.

Please note the pallet racking system must be designed to suit the pallet type being stored, not all pallets can be stored the same way. Refer to the system design and specifications before using the system.

Australian Standard Pallet Size

1165mm long x 1165mm wide x 150mm high
Tare Weight 38.5kgs



Safety Guidelines

Load Capacity:

Each component of the selective pallet racking system, including uprights, beams, and wire decks, has a designated load capacity. It is essential to adhere to the load capacity ratings provided by the manufacturer to ensure the structural integrity and safety of the racking system. The load capacity can vary based on factors such as beam length, beam profile, beam spacing, and the quality and condition of the components. It is crucial to consider the weight of the pallets, products, and any additional equipment, such as pallet jacks or forklifts, when determining the load capacity.

The allowable beam deflection for pallet racking beams can vary depending on several factors, including the specific standards and regulations followed in a particular country or region, the type of racking system, and the load capacity requirements. It is important to consult the applicable standards and guidelines specific to your location.

The allowable beam deflection for pallet racking beams must not exceed $L/180$, where L represents the length of the beam span. This means that the maximum deflection of the beam should not exceed $1/180^{\text{th}}$ of the span length. For example, if the span length is 3000, the maximum allowable deflection would be approximately 16.66mm.

These deflection limits are typically established to ensure the structural integrity and safety of the racking system and to prevent excessive sagging or deformation that could compromise its load-bearing capacity. It is crucial to adhere to the specific standards and guidelines applicable to your region to ensure compliance with safety regulations and best practices.

Allowable deflection in beam after loading

Length of Beam / 180 = Maximum Deflection

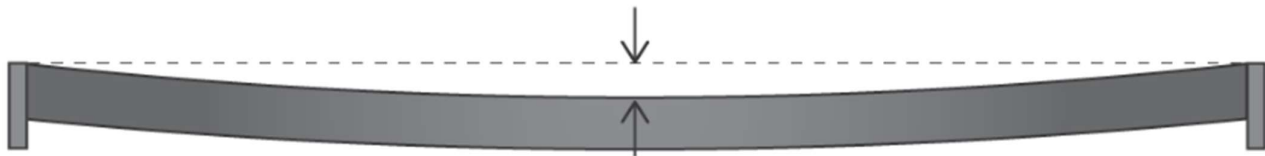

Weight Distribution:

Proper weight distribution is essential to maintain the stability and safety of the selective pallet racking system. Distribute the weight evenly across the load beams and ensure that the load is centered on the beams, rather than concentrated towards one end. Avoid overloading individual pallets or placing excessively heavy items on higher shelves, as this can lead to imbalanced weight distribution and potential structural failure. If using pallets of different sizes or weights, ensure that they are placed on appropriate beam levels that can support their weight. It is recommended to consult the manufacturer's guidelines or a structural engineer to determine the appropriate weight distribution for your specific racking system.

When it comes to pallet racking, proper weight distribution is crucial to ensure the structural integrity and stability of the racking system. Here are some guidelines for proper weight distribution on pallet racking:

1. Follow load capacity guidelines: Each pallet racking system has a specified load capacity, which should not be exceeded. It is important to consult the manufacturer's guidelines or the relevant industry standards to determine the maximum weight capacity for your specific racking system.
2. Distribute weight evenly: When loading the pallets onto the racking beams, distribute the weight evenly across the beams and ensure that the load is balanced from front to back and side to side. This helps maintain stability and prevents overloading on specific sections of the racking.
3. Place heavier items on lower levels: Heavier pallets or items should be placed on the lower levels of the racking system. This helps lower the centre of gravity, reducing the risk of instability or toppling.
4. Use appropriate load beams: Select load beams that match the weight capacity required for your specific load. Beams should be able to support the weight of the pallets without excessive deflection.
5. Consider load placement: Place heavier items closer to the vertical supports of the racking system, as they provide better load-bearing capacity. Lighter items can be positioned towards the centre or upper levels of the racking.

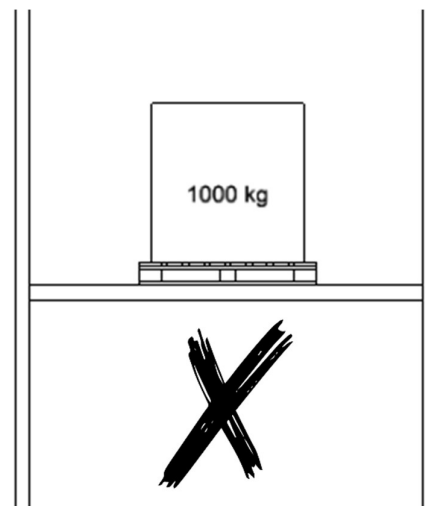
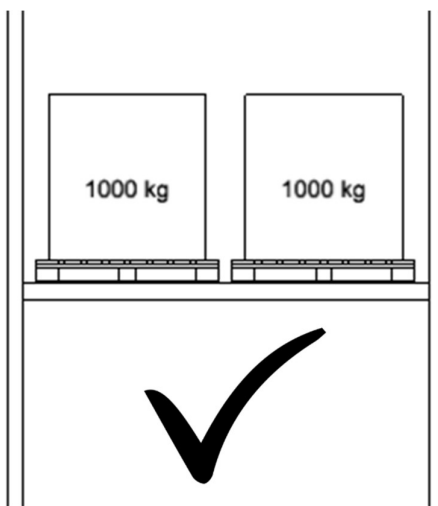

Load Handling and Stacking Techniques

Safe Load Handling:

Use appropriate lifting equipment, such as forklifts or pallet jacks, to handle pallets and loads. Ensure operators are trained and certified in proper equipment operation and load handling techniques. Follow safe lifting practices, such as positioning the forks correctly under the pallet and securing the load before lifting or moving.

Stable Load Placement and Securing:

Place pallets squarely and evenly on the load beams to maintain stability. Ensure that the load is properly aligned and centred on the beams, avoiding overhangs. Secure the load using appropriate methods, such as stretch wrapping or banding, to prevent shifting or falling during storage or transportation.

Stacking Height and Weight Limits:

Consider the height and weight limits specified by the manufacturer for safe stacking. Avoid exceeding the maximum allowable height or weight for the racking system, as it can compromise stability and safety.

Proper Pallet Orientation:

Ensure that pallets are properly oriented on the load beams, with the pallet base aligned parallel to the beams. Avoid placing pallets diagonally or at an angle, as it can affect stability and increase the risk of accidents.

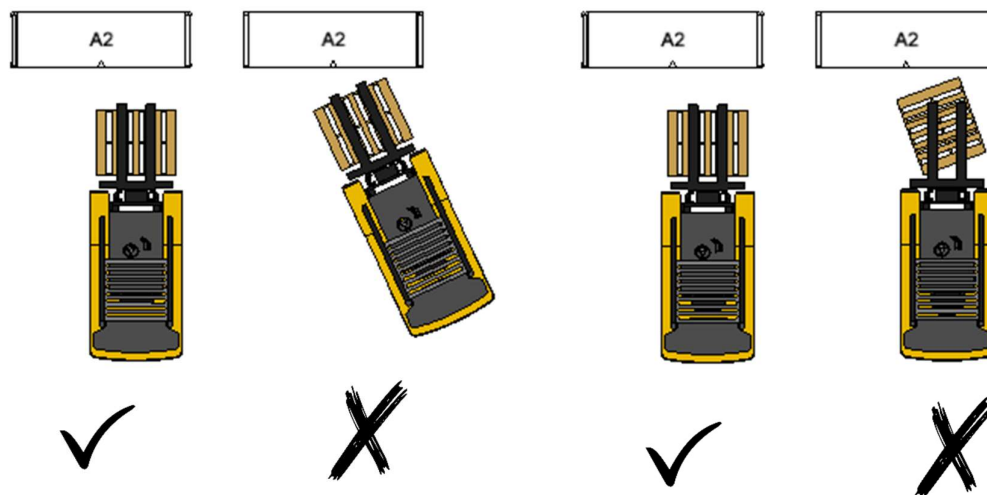

Overhang Prevention:

Avoid overhangs where the load extends beyond the edge of the pallet. Ensure that the load remains within the dimensions of the pallet to prevent instability or interference with adjacent pallets.

Caution with Fragile or Unstable Loads:

Exercise caution when handling fragile or unstable loads. Use additional measures, such as edge protectors or load stabilisers, to secure and protect such loads. Remember, proper load handling and stacking techniques are crucial to ensure the stability and safety of the selective pallet racking system. Adhering to these guidelines helps prevent accidents, product damage, and structural failures.

Aisle Safety and Clearances

Aisle safety and clearances are crucial considerations when operating a selective pallet racking system. Maintaining proper clearances and implementing safety measures helps prevent accidents, ensures smooth material handling operations, and protects both personnel and the racking system. Here are some key points to keep in mind:

Adequate Aisle Width:

Determine the required aisle width based on the type of material handling equipment being used, such as forklifts or reach trucks. Follow the manufacturer's guidelines or consult with a safety professional to determine the appropriate aisle width for your specific equipment. Leave enough space for operators to manoeuvre safely within the aisle, allowing for turning radius and any required lateral movements.

Clear Pathways:

Ensure that aisles are clear of obstructions, such as pallets, debris, or equipment. Implement regular housekeeping practices to maintain clear pathways, preventing accidents and improving overall efficiency.

Marked Aisles and Walkways:

Clearly mark aisles and walkways with visible floor markings or signage. Use arrows or labels to indicate the correct direction for traffic flow within the aisles. Clearly designate pedestrian walkways separate from equipment pathways, if applicable.

Obstacle Avoidance:

Identify any potential obstacles or hazards within the aisles, such as low-hanging lights, pipes, or fire suppression equipment. Ensure that these obstacles are clearly marked or protected to prevent collisions or damage.

Rack End Protection:

Install rack end protectors at the end of each row to prevent accidental impacts from forklifts or other equipment. Rack end protectors act as a barrier, absorbing impact energy and reducing the risk of damage to the racking system and products.

Safe Speed Limits:

Establish and enforce safe speed limits within the aisles to prevent accidents caused by excessive speed. Post speed limit signs and ensure that operators adhere to these limits.

Training and Awareness:

Provide proper training to all personnel who operate in the vicinity of the racking system. Ensure that operators are aware of the specific safety protocols, including aisle clearances, load capacity limits, and safe operating practices.

Regular Inspections:

Conduct routine inspections of the aisles and the racking system to identify any potential hazards or signs of damage. Address any issues promptly and follow through with necessary repairs or maintenance.

By maintaining proper aisle safety and clearances, you can minimise the risk of accidents, ensure efficient workflow, and prolong the lifespan of the selective pallet racking system.

Loading Pallets

Loading pallets into a selective pallet racking system involves following a systematic process to ensure safe and efficient placement. Here's a step-by-step guide:

Prepare the Work Area:

Ensure the aisle is clear and free of obstacles to allow unobstructed movement of forklifts or material handling equipment. Check that the racking system is in good condition, with no damaged or compromised components.

Select the Correct Pallet:

Choose a pallet that is suitable for the product being stored, considering size, weight, and load capacity of the racking system. Ensure the pallet is in good condition without any broken boards or protruding nails.

Inspect the Load Beams:

Check that the load beams are correctly aligned and adjusted to the desired height for the incoming pallet. Verify that the load beams have sufficient load capacity to support the weight of the pallet and its contents.

Position the Forklift:

Drive the forklift to the front of the racking system, aligning it with the desired location for the pallet. Position the forklift forks at an appropriate height to match the bottom of the pallet.

Lift the Pallet:

Carefully insert the forks of the forklift into the pallet, ensuring they are positioned evenly and securely under the pallet. Lift the pallet smoothly, keeping it level to prevent any load shifting or instability.

Manoeuvre the Forklift:

Slowly and cautiously drive the forklift towards the selected position within the racking system. Position the pallet squarely and aligned with the load beams.

Lower the Pallet:

Gradually lower the pallet onto the load beams, ensuring it is centred and fully supported by the beams. Lower the forks completely before moving the forklift away from the pallet.

Repeat the Process:

Repeat the above steps for each pallet being loaded, ensuring proper alignment and weight distribution.

Regular Inspections:

Conduct regular inspections of the loaded pallets and racking system to identify any signs of damage, instability, or load shifts. Adjust or reposition pallets as necessary to maintain stability and safety. Remember to always follow proper material handling procedures, prioritise safety, and adhere to load capacity guidelines specified by the manufacturer. Properly loaded pallets will ensure the stability of the racking system and facilitate easy access and retrieval of stored products.

Safe Working Load Signs

A Safe Working Load (SWL) sign is an important safety measure that provides information about the maximum weight that a specific structure, equipment, or lifting device can safely handle. The SWL sign is typically displayed prominently near the equipment or structure to ensure that operators and personnel are aware of the weight limitations and can adhere to them. Here are some key aspects of a SWL sign:

Clear and Visible Display:

The SWL sign should be clearly visible and positioned in a prominent location near the equipment or structure. It should be easily readable from a reasonable distance to ensure that personnel can quickly identify the weight limitations.

Standardised Format:

The SWL sign should follow a standardised format and include specific details to convey important information. The format typically includes a bold heading such as "Safe Working Load" or "Maximum Weight Capacity" to clearly indicate its purpose.

Weight Capacity Information:

The SWL sign should clearly state the maximum weight capacity of the equipment or structure. The weight capacity may be indicated in units such as kilograms (kg). It should be displayed prominently and in a legible font size to avoid any confusion or misinterpretation.

Relevant Information:

The SWL sign may also include additional information that is relevant to the safe operation of the equipment or structure. This may include any restrictions, limitations, or specific instructions related to the weight capacity. For example, it may indicate if the weight capacity is for evenly distributed loads or if there are restrictions on the load distribution or configuration.

Design and Durability:

The sign should be designed to withstand environmental conditions, including exposure to weather, moisture, and other potential hazards. It should be made of durable materials that can withstand normal wear and tear, ensuring that the sign remains legible and intact over time.

Compliance with Regulations:

Ensure that the SWL sign complies with relevant safety regulations and standards specific to the equipment or structure.

It's important to note that the SWL sign is not just a formality but a critical safety measure. Operators and personnel should always adhere to the weight limitations specified on the SWL sign to prevent overloading and potential accidents. Regular inspections and maintenance of the equipment or structure are essential to ensure that the stated weight capacity remains accurate and reliable.

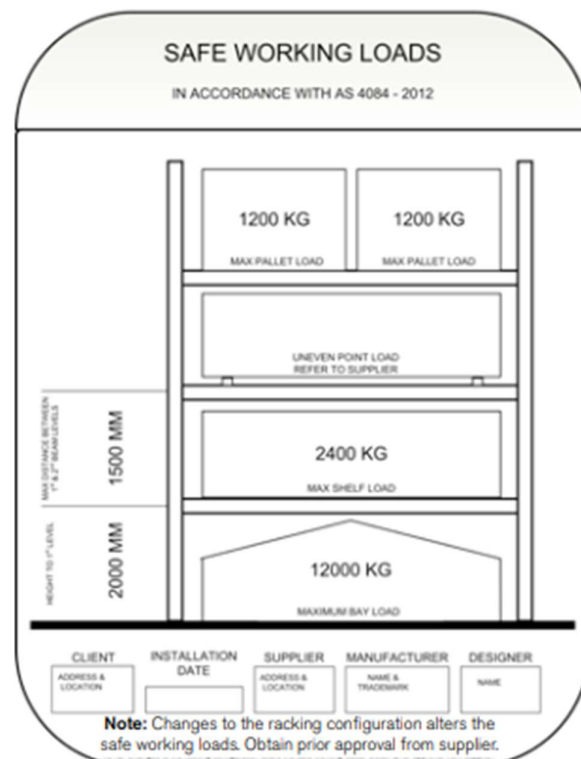

Maintenance and Inspections

Maintenance and regular inspections are essential for ensuring the safety, longevity, and optimal performance of pallet racking systems. Pallet Racking must be inspected every 12 months. Here are some key considerations for maintenance and inspections:

Scheduled Inspections:

Establish a regular inspection schedule every 12 months for the pallet racking system, adhering to industry standards and manufacturer recommendations. Conduct thorough inspections at predetermined intervals, such as annually or semi-annually, and document the findings.

Visual Inspections:

Perform visual inspections of the racking system on a regular basis, even between scheduled inspections. Look for signs of damage, including bent or twisted components, cracked welds, missing or damaged safety clips or anchors, or any other visible defects.

Load Capacity Verification:

Ensure that the load capacity of the racking system is not exceeded. Regularly review and verify the load capacity ratings specified by the manufacturer. Consider any changes in storage requirements or load characteristics to ensure ongoing compliance with load capacity limits.

Damage Assessment and Repair:

If any damage or defects are identified during inspections, promptly assess the severity, and take appropriate action. Minor damages, such as bent beams or damaged safety clips, may be repairable, while significant structural issues may require expert evaluation and repair. Consult with qualified personnel or the manufacturer to determine the appropriate repair methods and ensure compliance with safety standards.

Rack Protection Measures:

Implement rack protection measures, such as rack guards or post protectors, to minimise the risk of damage from forklift impacts. Regularly inspect and maintain these protective elements to ensure their effectiveness.

Housekeeping and Load Placement:

Encourage good housekeeping practices to maintain a clean and organised storage environment. Ensure that pallets are loaded and positioned correctly to distribute the load evenly across the beams and avoid overloading specific areas.

Staff Training and Education:

Provide training to employees involved in the operation, maintenance, and inspection of the pallet racking system. Educate staff members on safe operating practices, load capacity limits, and the importance of reporting any observed damage or concerns.

Documentation and Record-Keeping:

Maintain thorough records of inspections, repairs, and maintenance activities. Document any identified issues, the actions taken, and their resolutions. Keep track of any modifications or changes made to the racking system and contact the supplier immediately.

Regular maintenance and inspections contribute to the overall safety, reliability, and performance of the pallet racking system. By addressing any issues promptly and adhering to recommended maintenance practices, you can ensure a well-maintained and secure storage infrastructure for your operations.

Damage Identification to uprights

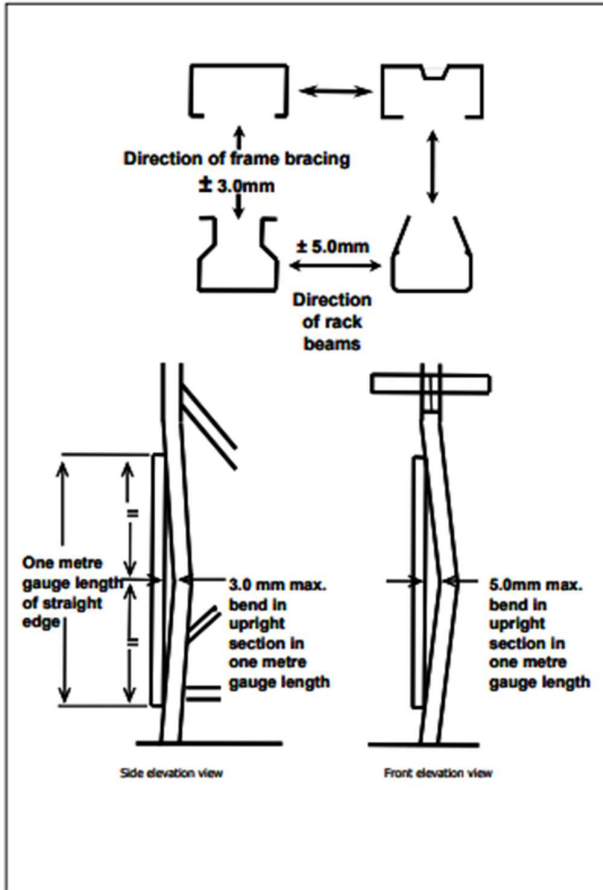

Damaged Upright



Damaged Upright

Damage Action Flow Chart

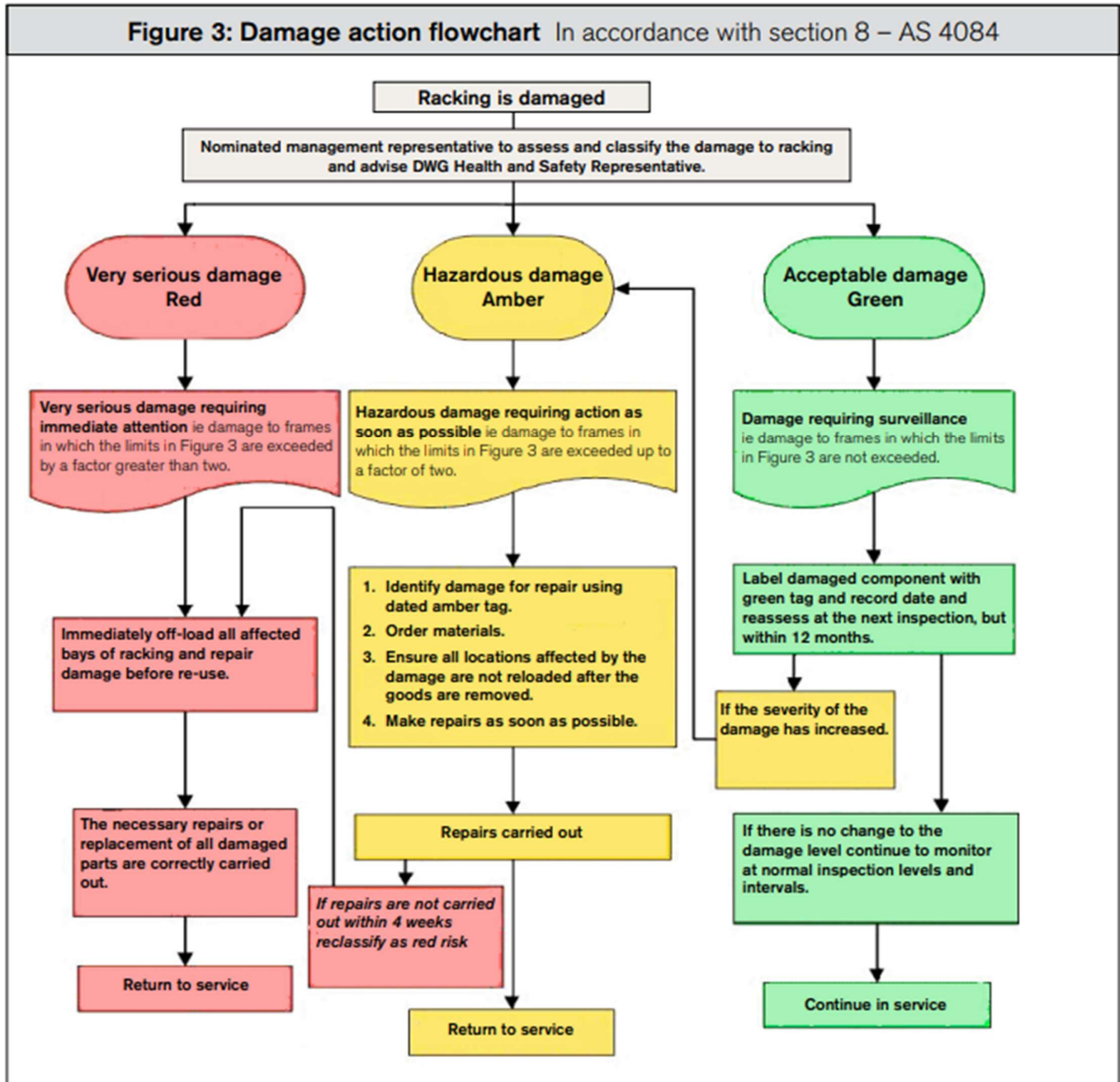

Repair and Replacement of Components

Repair and replacement of components in a pallet racking system are necessary to maintain its structural integrity and ensure safe storage of goods. Here are some guidelines for repairing and replacing components:

Inspection and Evaluation:

Regularly inspect the pallet racking system to identify any damaged or compromised components. Assess the severity of the damage, considering factors such as the type of damage, its location, and the potential impact on the system's overall stability.

Manufacturer Guidelines:

Consult the manufacturer's guidelines, specifications, and documentation to understand the recommended repair and replacement procedures for the specific components in your pallet racking system. Follow the manufacturer's instructions to ensure compliance with safety standards and to maintain any applicable warranties.

Qualified Personnel:

Engage qualified personnel with expertise in pallet racking systems to perform repairs and replacements. These professionals should have a thorough understanding of the system's design, engineering principles, and relevant safety regulations.

Component Repair:

For minor damage, such as bent beams or damaged safety clips, consult with experts to determine if the component can be repaired. Follow recommended repair methods and techniques provided by the manufacturer or an authorised professional. Ensure that the repaired component is restored to its original strength and integrity.

Component Replacement:

If the damage is significant or beyond repair, you must replace the affected component. Replace damaged upright frames, beams, connectors, or any other critical components according to the manufacturer's specifications. Use replacement parts from the manufacture that match the existing pallet racking system to maintain its structural integrity and load capacity.

Professional Assistance:

When in doubt about the extent of damage or the appropriate repair or replacement methods, seek professional assistance. Engage with manufacturers, suppliers, or qualified engineering firms specialised in pallet racking systems for expert guidance and support.

Documentation:

Keep a detailed record of all repair and replacement activities performed on the pallet racking system. Document the specific components repaired or replaced, the date of the repair/replacement, and any relevant notes or observations. This documentation will help track the maintenance history of the system and aid in future inspections and assessments.

Remember that the safety and stability of the pallet racking system should never be compromised. If significant damage or safety concerns arise, it may be necessary to temporarily close off the affected area or seek professional advice before proceeding with repairs or replacements.

